

PIERCING PUNCH 'D' TYPE

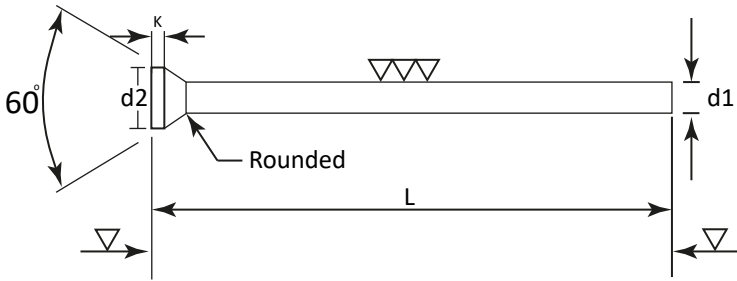

PUNCH AS PER DIN 9861, IS - 4296

TYPE D CSK HEAD.

d1	h6	d2	K+ 0.2
0.5	-0.007	0.9	0.2
0.6		1.1	
0.7		1.3	
0.8		1.4	
0.9		1.6	
1.0 - 1.1		1.8	0.4
1.2 - 1.3		2.0	
1.4 - 1.5		2.2	
1.6 - 1.7		2.5	
1.8 - 1.9		2.8	
2.0	3.0	0.5	
2.1 - 2.2	3.2		
2.3 - 2.5	3.5		
2.6 - 2.9	4.0		
3.0	4.5		
3.1 - 3.4	4.5		
3.5 - 3.9	5.0		
4.0 - 4.4	-0.008	5.5	2.5
4.5 - 4.9		6.0	

d1	h6	d2	K+ 0.2
5.0 - 5.4	-0.008	6.5	0.5
5.5 - 5.9		7	
6.0		8	
6.1 - 6.4	-0.011	8	1.0
6.5 - 7.0		9	
7.5 - 8.0		10	
8.5 - 9.0		11	
9.5 - 10.0		12	
10.5 - 11.0		13	
11.5 - 12.0		14	
12.5 - 13.0	16	1.5	
13.5 - 14.0	16		
14.5 - 15.0	17		
15.5 - 16.5	18		
17.0	19		
18.0	0.015	20	2.1
19.0		21	
20.0		22	

LENGTH - 50 , 70 , 80 , 100

MATERIAL - HSS M2 GRADE

HARDNESS - SHANK 60 ± 2 HRC

HEAD 45 ± 2 HRC

NOTE - OTHER SIZE CAN BE MADE AVAILABLE ON REQUEST